







Okanagan Basin
WATER BOARD

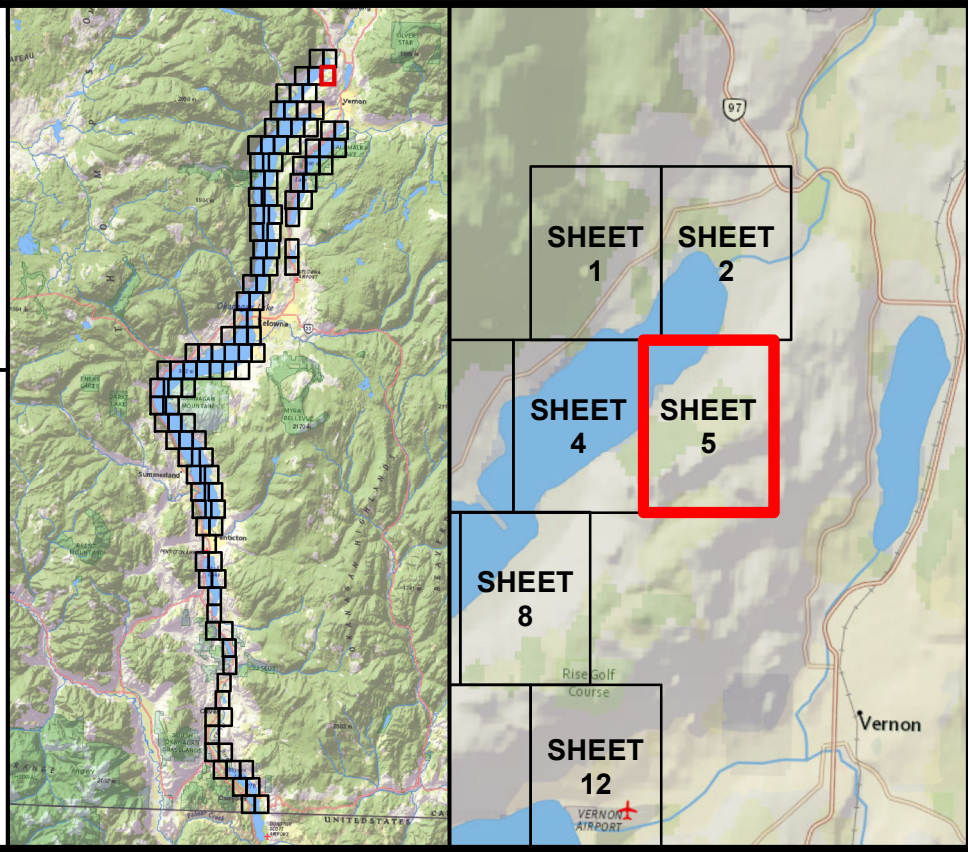

northwest hydraulic consultants

30 Gostick Place
North Vancouver, B.C. V7M 3G3
Canada
Office: 604.980.6011
Fax: 604.980.9264
www.nhweb.com





FLOW DIRECTION

- SPOT ELEVATION
labelled with elevation in metres (CGVD2013)
- MINOR CONTOUR AT 1 M INTERVAL
- MAJOR CONTOUR AT 5 M OR 20 M INTERVAL
labelled with elevation in metres (CGVD2013)
- DIKE
- RAILWAY LINE
- FIRST NATION RESERVE BOUNDARY
- MUNICIPAL BOUNDARY
- REGIONAL DISTRICT BOUNDARY
- STUDY LIMIT

REFER TO NOTES ON INDEX MAP

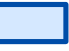

INUNDATION EXTENT - DESIGN WITH FREEBOARD (FCL)

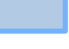

INUNDATION EXTENT - DESIGN WITHOUT FREEBOARD

123.4
(123.1)

123.4
(123.4)

123.4
(123.4)

123.4
(123.4)

DESIGN FLOOD

- OKANAGAN RIVER REACHES: 200-YEAR MID-CENTURY^a
- OKANAGAN LAKE: 2017 MID-CENTURY^b
- WOOD AND KALAMALKA LAKES: 2017 MID-CENTURY^b
- ELLISON LAKE: 200-YEAR MID-CENTURY
- SKAHA LAKE: 200-YEAR MID-CENTURY
- VASELUX LAKE: 200-YEAR MID-CENTURY
- OSOYOOS LAKE: 200-YEAR MID-CENTURY
- FREEBOARD = 0.6 METRES

^a "Mid-century" refers to an increase for climate change, projected to occur in 2055.
^b The 2017 flood is the flood-of-record at Okanagan, Wood, and Kalamalka lakes, and is used as the design flood at these locations because it is larger than a 200-year event.

OKANAGAN 1
VERNON

**OKANAGAN MAINSTEM
FLOOD MAPPING
FLOODPLAIN MAPS**

SHEET 5 OF 116

SCALE - 1:5,000

0 100 200 300 M

Coordinate System: NAD 1983 CSRS UTM ZONE 11N
Units: METRES; Vertical Datum: CGVD2013
FCL values in both CGVD2013 and CGVD28 HTV2.0

Engineer	GIS	Reviewer
VCCB	MSN/MAO/SWM	DPM (rivers)/GFL (lakes)/PKK
Job Number	Date	
3004430 & 3006034	30-APR-2020, rev. 29-JAN-2021	